



---

## Lexmark CX943adtse

Powerful, large-format addition to your printer fleet

---



# Lexmark CX943adtse

The Lexmark CX943adtse large-format colour multifunction is designed for security, versatility and performance for large workgroups at speeds up to 55 pages per minute\*. Loaded with standard features, this model includes a 25 cm touchscreen, single-pass two-sided scanning with ultrasonic multi-feed detection and Optical Character Recognition (OCR).



## Productivity is in the box

- ▶ Maximise productivity with workflow solutions like Scan Centre for simple document routing and single-pass two-sided scanning with ultrasonic multi-feed detection for fast and reliable scanning.
- ▶ The Intelligent Storage Drive (ISD) provides solid state storage with activation-ready preloaded add-on solutions.
- ▶ A large, button-free touchscreen helps users intuitively complete every task, from the basic to the complex.

## Flexible input and output

- ▶ Print and scan large-format paper sizes slightly larger than SRA3+ (up to 329 x 483 mm).
- ▶ Standard input capacity is 2,180 pages; optional additional trays expand paper input capacity up to 4,180 pages.
- ▶ Several finishing options are available: staple finisher, staple hole punch finisher, booklet finisher or Lexmark's first trifold/Z-fold finisher.

## Professional colour for large-format printing

- ▶ Enjoy vibrant colour with standard advanced features like PANTONE® calibration and Lexmark Named Colour

Replacement for consistent branding and professional appearance.

- ▶ Replacement cartridges yield up to 45,000/22,000 black/colour pages\*\*.

## Secure by design

- ▶ Lexmark security features help keep your information safe - in the document, on the device, over the network and at all points in between.
- ▶ Always improving security, we now include a standard Trusted Platform Module\*\*\*, which delivers authentication, system integrity checks, and cryptographic capabilities to create a unique digital system fingerprint.
- ▶ A proximity sensor wakes up the device when someone is nearby and automatically logs off when no one is nearby.

## Sustainability matters

- ▶ CX943adtse is designed for the circular economy.
- ▶ Automatic two-sided printing is standard, along with built-in energy-saving modes that help support ratings of EPEAT® Silver and ENERGY STAR® certified.
- ▶ The award-winning Lexmark Cartridge Collection Programme (LCCP) and Lexmark Equipment Collection Programme (LECP) minimise waste and support recycling (availability varies by country).

## Power up with IoT

- ▶ Our sophisticated, IoT-enabled printers are loaded with sensors that continuously monitor hundreds of data points.
- ▶ When you connect your device to Lexmark Cloud Services, you can optimise performance and uptime with additional features like predictive service and automatic supplies replenishment.

This is a Class A device according to international electromagnetic emissions standards (i.e. FCC Rules, EN 55022/EN 55032, etc.). Class A products are intended for use in non-residential/non-domestic environments. Use of a Class A product in residential/domestic environments may cause interference to radio communications and require corrective measures.

\* Print speeds measured in accordance with ISO/IEC 24734 (ESAT). For more information see: [www.lexmark.com/ISOspeeds](http://www.lexmark.com/ISOspeeds).

\*\* Average continuous black or continuous composite colour (CMY) declared yield in one-sided (simplex) mode up to this number of pages in accordance with ISO/IEC 19798. Actual yield will vary considerably based upon many factors. See [www.lexmark.com/yields](http://www.lexmark.com/yields) for more information.

\*\*\* The Trusted Platform Module (TPM) is not available in some countries.

# Lexmark CX943adtse

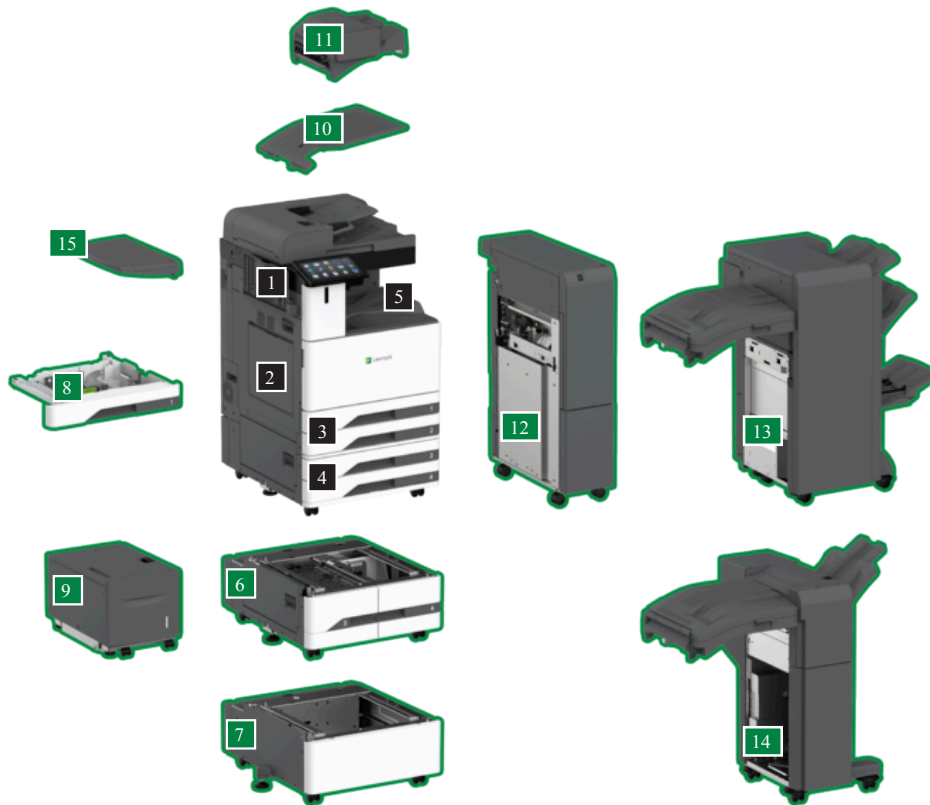

- 1 **Multifunction product with 25 cm touch screen**  
1141 x 620 x 754 mm
- 2 **100-Sheet multipurpose feeder**  
Dimensions included as part of base model
- 3 **2 x 520-Sheet tray**  
Dimensions included as part of base model
- 4 **2 x 520-Sheet tray with casters**  
Dimensions included as part of base model
- 5 **400-Sheet output bin**  
Dimensions included as part of base model
- 6 **2000-Sheet Tandem Tray with Caster**  
305.2 x 668.5 720 mm
- 7 **Caster Spacer**  
305 x 669 x 720 mm
- 8 **Envelope Tray**  
89.9 x 619.9 x 565.5 mm
- 9 **2000-Sheet Tray**  
491 x 751 x 526 mm

- 10 **Dual Catch Bin**  
125 x 474 x 380 mm
- 11 **500-Sheet Staple Offset Finisher**  
238 x 478 x 460.5 mm
- 12 **Zfold Trifold option for Booklet Finisher**  
991 x 232 x 726 mm
- 13 **1500-Sheet Booklet Staple 2/3 Hole Punch Finisher**  
1056 x 790 x 589 mm
- 14 **2000-Sheet Staple 2/3 Hole Punch Finisher**  
983 x 962 x 653 mm
- 15 **Work Table**  
82 x 303 x 528 mm

- Standard
- Optional

<b>P/N</b>	<b>Hardware</b>
32D0370	Lexmark CX943adtse
<b>P/N</b>	<b>Supplies</b>
73D0P00	Lexmark CX942, 943, 944, XC9445, 55, 65 Black 165K Photoconductor
73D0Q00	Lexmark CX942, 943, 944, XC9445, 55, 65 3-Pack 165K Photoconductor Kit
73D0W00	Lexmark CX942, 943, 944, XC9445, 55, 65 35K Waste Container
83D0HCO	Lexmark CX942, 943, 944 Cyan 22K Toner Cartridge
83D0HKO	Lexmark CX942, 943, 944 Black 45K Toner Cartridge
83D0HMO	Lexmark CX942, 943, 944 Magenta 22K Toner Cartridge
83D0HYO	Lexmark CX942, 943, 944 Yellow 22K Toner Cartridge
<b>P/N</b>	<b>Paper Handling</b>
32D0811	CS94x/CX94x 2 x 520-Sheet Tray
32D0812	CS94x/CX94x 2000-Sheet Tandem Tray with Caster
32D0813	CS94x/CX94x Envelope Tray
32D0816	CX93x/MX93x/CS94x/CX94x 2000-Sheet Tray
32D0819	CS94x/CX94x Dual Catch Bin
32D0820	CX93x/MX93x/CS94x/CX94x 500-Sheet Staple Offset Finisher
32D0823	CS94x/CX94x 2000-Sheet Staple 2/3 Hole Punch Finisher
32D0824	CS94x/CX94x 2000-Sheet Staple 2/4 Hole Punch Finisher
32D0825	CS94x/CX94x 1500-Sheet Booklet Staple 2/3 Hole Punch Finisher
32D0826	CS94x/CX94x 1500-Sheet Booklet Staple 2/4 Hole Punch Finisher
32D0828	CS94x/CX94x 2000-Sheet Staple Swedish Hole Punch Finisher
32D0831	CS94x/CX94x Zfold Trifold option for Booklet Finisher
<b>P/N</b>	<b>Memory Options</b>
27X0400	500+ GB Hard Disk
<b>P/N</b>	<b>Application Solutions</b>
57X0300	Contact Authentication Device
57X0301	Contactless Authentication Device
82S1203	IPDS License
82S1204	Bar Code License
<b>P/N</b>	<b>Connectivity</b>
1021294	USB (2 Meter) Cable
14F0100	RS-232C Serial Interface Card
27X0142	Lexmark MarkNet™ N8230 Fiber Ethernet Print Server
27X6410	Lexmark MarkNet N8372 802.11 a/b/g/n/ac Wireless Print Server
57X7040	English Keyboard Kit
SPD0002	Surge Protective Device, 220-240V
<b>P/N</b>	<b>Furniture</b>
32D0809	CX94x Work Table
32D0810	CS94x/CX94x Caster Spacer

You can install one of the following: the Dual Catch Bin or the Inline Staple Finisher or the Staple Hole Punch Finisher or the Booklet Staple Hole Punch Finisher. To install the Tri-Fold/Z-Fold Finisher, you must also install the Booklet Staple Hole Punch Finisher. To install the Staple Hole Punch Finisher or Booklet Staple Hole Punch Finisher, you must also install the 2x520-Sheet Tray with Casters, the 2,000-Sheet Tandem Tray with Casters, or the Caster Spacer. To install the 2,000-Sheet Tray (sidecar), you must also install the 2x520-Sheet Tray with Casters or the 2,000-Sheet Tandem Tray with Casters. It will not work with the Caster Spacer. To install the Envelope Tray, you must remove Tray 1 and replace it with the Envelope Tray.

## Product Specifications

## Lexmark CX943adtse

Printing	
Display	Lexmark e-Task 10-inch (25 cm) class colour touch screen
Print Speed	Up to: Black: 55 ppm <sup>1</sup> (A4) / Colour: 55 ppm <sup>1</sup> (A4)
Time to First Page	As fast as: Black: 4.9 seconds / Colour: 4.9 seconds
Print Resolution	Black: 1200 x 1200 dpi, 2400 IQ (2400 x 600 dpi) / Colour: 1200 x 1200 dpi, 2400 IQ (2400 x 600 dpi)
Memory	Standard: 4096 MB / Maximum: 4096 MB
Hard Disk	Intelligent Storage Drive included; Magnetic Hard Disk available
Recommended Monthly Page Volume	7,000 - 50,000 pages <sup>2</sup>
Maximum Monthly Duty Cycle	Up to: 270 000 pages per month <sup>3</sup>
Copying	
Copy Speed	Up to: Black: 55 cpm <sup>1</sup> (A4) / Colour: 55 cpm <sup>1</sup> (A4)
Time to First Copy	as fast as: Black: 6.8 seconds / Colour: 6.4 seconds
Scanning	
Scanner Type / ADF Scan	Flatbed scanner with automatic document feeder / DADF (single pass Duplex)
A4/Ltr Duplex Scan Speed	Up to: Black: 146/144 sides per minute / Colour: 146/144 sides per minute
A4/Ltr Simplex Scan Speed	Up to: Black: 73.5/72 sides per minute / Colour: 73.5/72 sides per minute
ADF Paper Input Capacity	Up to: 130 pages 75 gsm bond
Faxing	
Modem Speed	ITU T.30, V.34 Half-Duplex, 33.6 Kbps
Supplies <sup>4</sup>	
Laser Cartridge Yields	up to: 22,000 <sup>5</sup> -page Colour (CMY) Cartridges / up to: 45,000 <sup>5</sup> -page Black Cartridge
Cartridge(s) Shipping with Product	18,500 <sup>5</sup> -page Black Toner Cartridge, 11,500 <sup>5</sup> -page Color (CMY) Toner Cartridges
Paper Handling	
Included Paper Handling	100-Sheet Multipurpose Feeder, 2 x 520-Sheet Tray, 400-Sheet Output Bin, 2 x 520-Sheet Tray/Caster
Optional Paper Handling	Booklet staple hole punch finisher, Inline Stapler, Dual Catch Bin, Envelope Tray, Caster spacer, Tri-fold/Z-fold booklet finisher, Staple Punch Finisher, Work table, 2000-Sheet Tray, 2000-Sheet Tandem Tray/Caster
Paper Input Capacity	Up to: Standard: 2180 pages 75 gsm bond / Maximum: 4180 pages 75 gsm bond
Paper Output Capacity	Up to: Standard: 400 pages 75 gsm bond / Maximum: 3600 pages 75 gsm bond
Media Types Supported	Labels, Card Stock, Plain Paper, Envelopes, Glossy paper, Refer to the Paper & Specialty Media Guide
Media Sizes Supported	A6, Oficio, 7 3/4 Envelope, JIS-B4, 9 Envelope, B5, JIS-B5, A3, Ledger, A4, Legal, SRA3, A5, Hagaki Card, Letter, B5 Envelope, C4 Envelope, Statement, C5 Envelope, Executive, DL Envelope, Folio, 10 Envelope
General Information	
Standard Connectivity	Gigabit Ethernet (10/100/1000), Front USB 2.0 Specification Hi-Speed Certified port (Type A), Rear USB 2.0 Specification Hi-Speed Certified port (Type A), USB 2.0 Specification Hi-Speed Certified (Type B), One Internal Card Slot
Optional Network Ports / Optional Local Ports	MarkNet N8230 Fiber Ethernet Print Server, Marknet N8372 WiFi Option / Internal RS-232C serial
Noise Level	Operating: 49 dBA (Print) / 57 dBA (Copy) / 56 dBA (Scan)
Specified Operating Environment	Humidity: 8 to 80% Relative Humidity / Altitude: 0 - 2500 Meters (8,200 Feet) / Temperature: 10 to 32°C (50 to 90°F)
Product Guarantee	1-Year Onsite Repair, Next Business Day
Size / Weight	H x W x D: 1141 x 620 x 754 mm / 115.5 kg
ENERGY STAR Typical Electricity Consumption	TEC: 0.85 kilowatt-hours per week

All information is subject to change without notice. Lexmark is not liable for any errors or omissions.

<sup>1</sup> Print and copy speeds measured in accordance with ISO/IEC 24734 and ISO/IEC 24735 respectively (ESAT). For more information see: [www.lexmark.com/ISOspeeds](http://www.lexmark.com/ISOspeeds).

<sup>2</sup> "Recommended Monthly Page Volume" is a range of pages that helps customers evaluate Lexmark's product offerings based on the average number of pages customers plan to print on the device each month. Lexmark recommends that the number of pages per month be within the stated range for optimum device performance, based on factors including: supplies replacement intervals, paper loading intervals, speed, and typical customer usage. <sup>3</sup> "Maximum Monthly Duty Cycle" is defined as the maximum number of pages a device could deliver in a month using a multishift operation. This metric provides a comparison of robustness in relation to other Lexmark printers and MFPs. <sup>4</sup> Product functions only with replacement cartridges designed for use in a specific geographical region. See [www.lexmark.com/regions](http://www.lexmark.com/regions) for more details. <sup>5</sup> Average continuous black or continuous composite CMY declared cartridge yield up to this number of standard pages in accordance with ISO/IEC 19798.

This is a Class A device according to international electromagnetic emissions standards (i.e. FCC Rules, EN 55022/EN 55032, etc.). Class A products are intended for use in non-residential/non-domestic environments. Use of a Class A product in residential/domestic environments may cause interference to radio communications and require corrective measures.

© 2022 Lexmark. All rights reserved.

Lexmark and the Lexmark logo are trademarks of Lexmark International, Inc., registered in the United States and/or other countries.

Apple and AirPrint are trademarks of Apple Inc., registered in the U.S. and other countries and regions. MOPRIA®, the Mopria® Logo, and the Mopria Alliance™ word mark and logo are registered and/or unregistered trademarks and service marks of Mopria Alliance, Inc. in the United States and other countries. Unauthorised use is strictly prohibited. ENERGY STAR and the ENERGY STAR mark are registered trademarks owned by the U.S. Environmental Protection Agency. EPEAT is a trademark of the Green Electronics Council in the United States and other countries. PANTONE® is the property of Pantone LLC. All other trademarks are the property of their respective owners.

This product includes software developed by the OpenSSL Project for use in the Open SSL Toolkit (<http://www.openssl.org/>).



[lexmark.com](http://lexmark.com)